

Date	10/04/2016	
Diagram created for: Keith Estes, 678-374-5934		

Site Diagram

Demarc Extension

Client	Pratt Industries
Site	Cincinnati OH

IN STRICT CONFIDENCE. All rights reserved. Disclosure to third parties of this document or any part thereof, or the use of any information contained therein for purposes other than provided for by this document is not permitted, except with the express written permission of Scott M. Conkel and/or Georgia Low Voltage Technologies Inc.

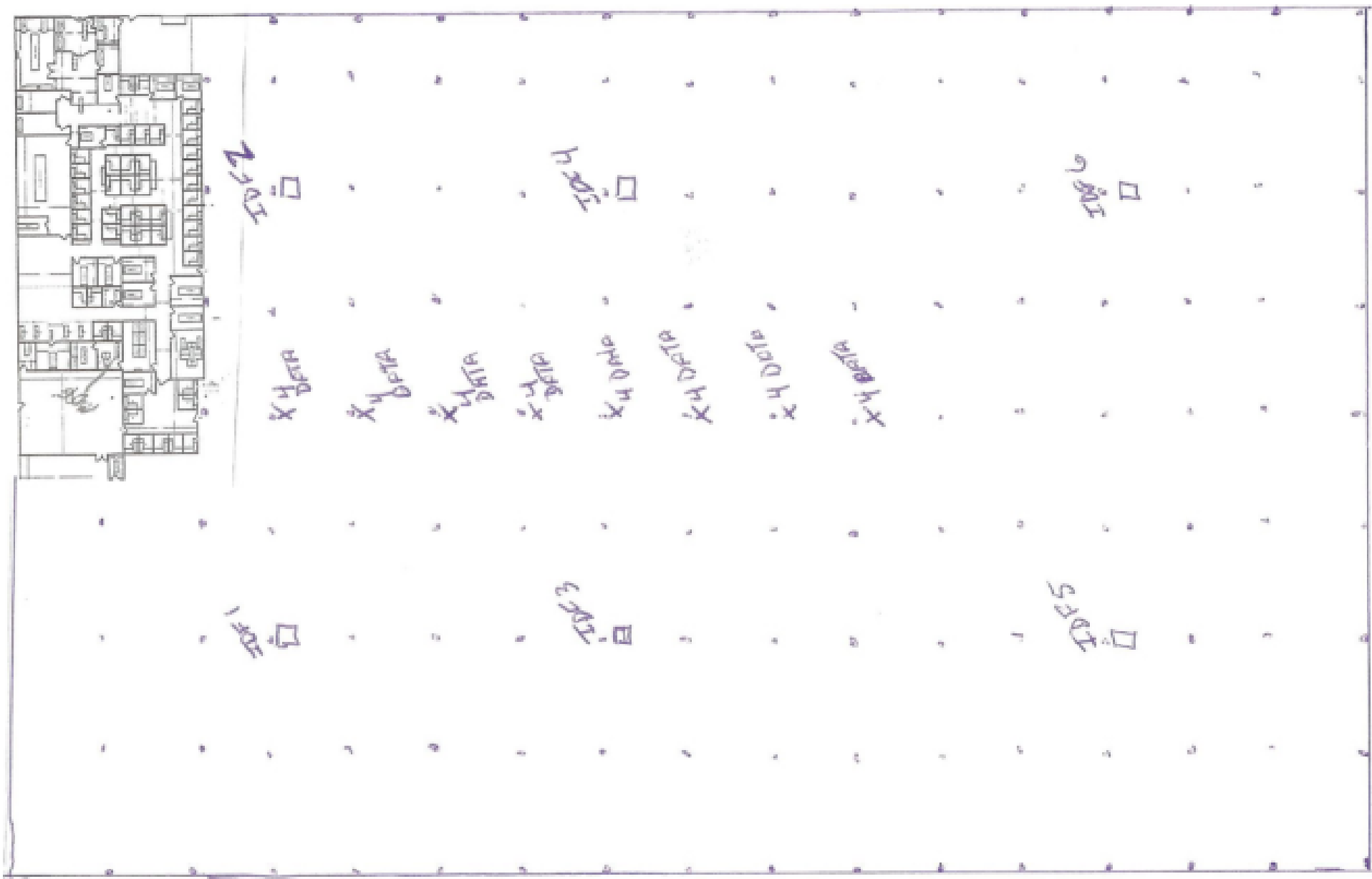

Block Diagram

Demarc Extension

Client	Pratt Industries
Site	Cincinnati OH

IN STRICT CONFIDENCE. All rights reserved. Disclosure to third parties of this document or any part thereof, or the use of any information contained therein for purposes other than provided for by this document is not permitted, except with the express written permission of Scott M. Conkel and/or Georgia Low Voltage Technologies Inc.

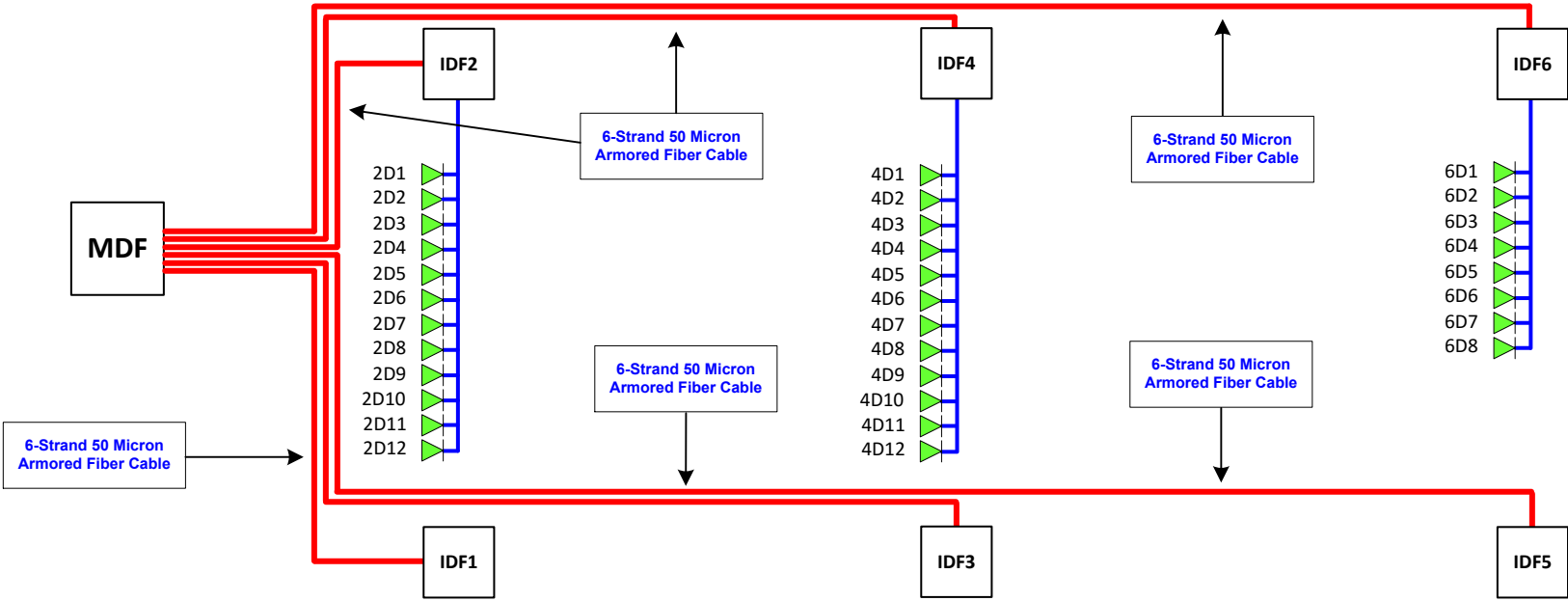

Site Diagram

Demarc Extension

Client	Pratt Industries
Site	Cincinnati OH

IN STRICT CONFIDENCE. All rights reserved. Disclosure to third parties of this document or any part thereof, or the use of any information contained therein for purposes other than provided for by this document is not permitted, except with the express written permission of Scott M. Conkel and/or Georgia Low Voltage Technologies Inc.

◀ New Data Drop

■ Wall/Pole Mount Cabinet ■ DEMARC

Demarc Extension Provided by Carrier

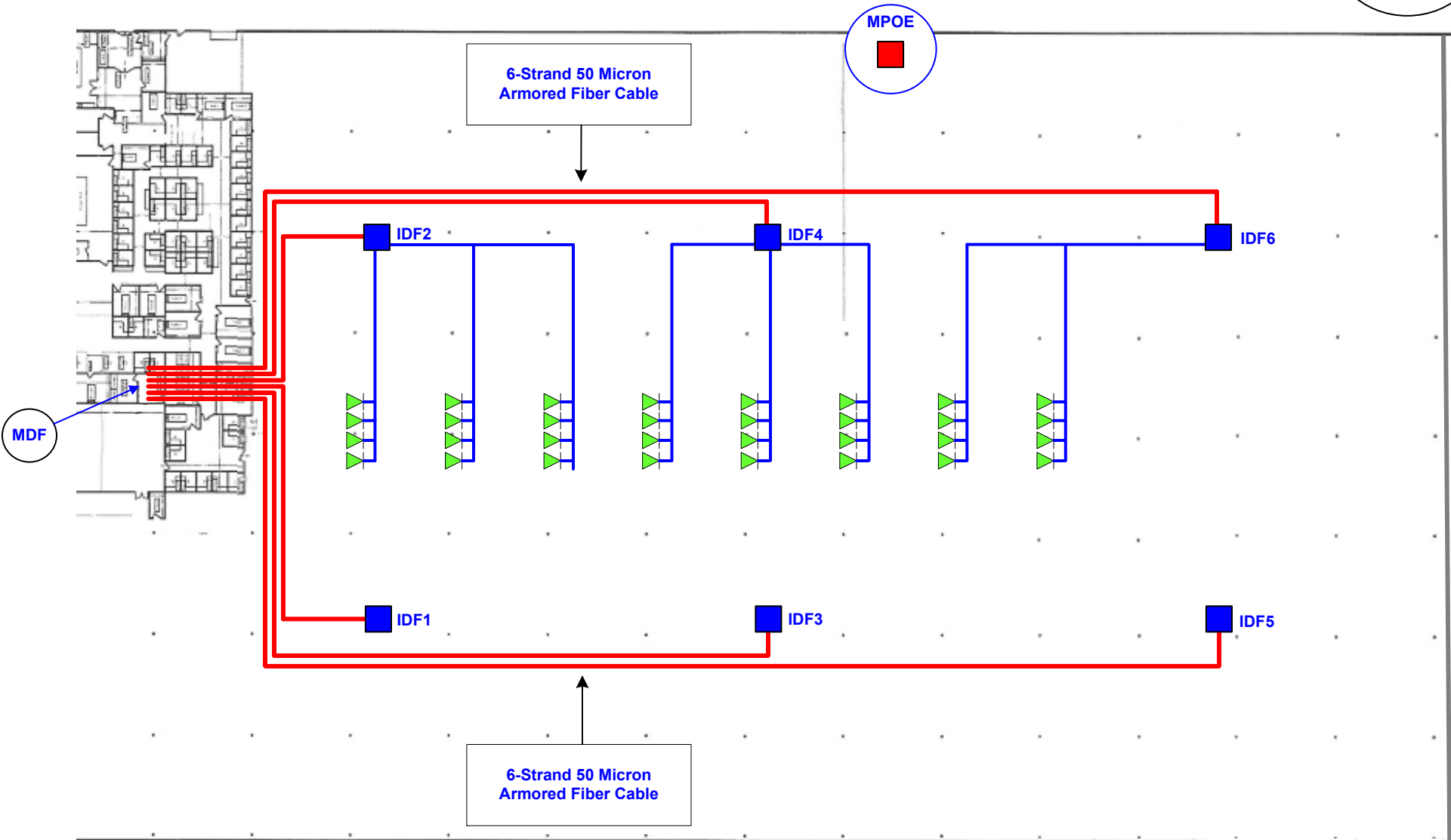

Fiber Connections

Demarc Extension

Client	Pratt Industries
Site	Cincinnati OH

IN STRICT CONFIDENCE. All rights reserved. Disclosure to third parties of this document or any part thereof, or the use of any information contained therein for purposes other than provided for by this document is not permitted, except with the express written permission of Scott M. Conkel and/or Georgia Low Voltage Technologies Inc.

- All fiber media converters will be SC / RJ45
- All fiber connectors, coupler panels will be SC
- All fiber patch cables will be SC / SC

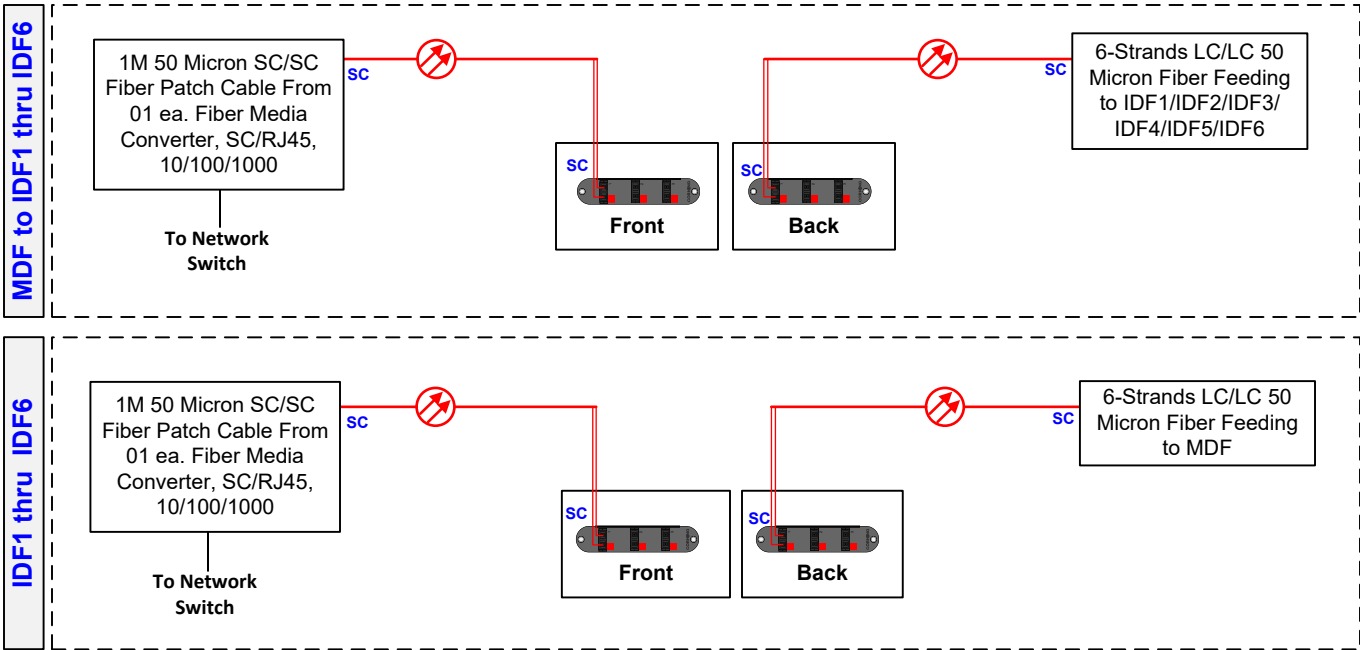

Site Diagram

Demarc Extension

Client	Pratt Industries
Site	Cincinnati OH

IN STRICT CONFIDENCE. All rights reserved. Disclosure to third parties of this document or any part thereof, or the use of any information contained therein for purposes other than provided for by this document is not permitted, except with the express written permission of Scott M. Conkel and/or Georgia Low Voltage Technologies Inc.

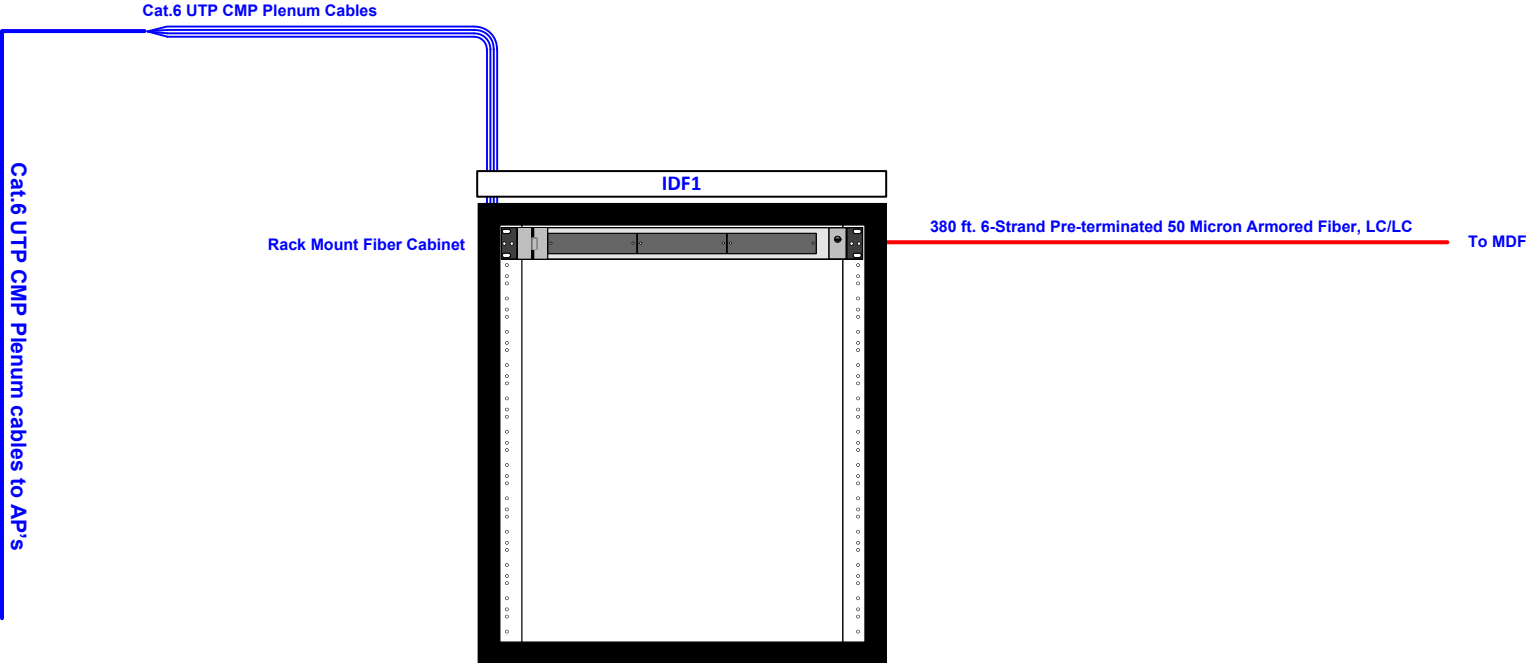

- 01 ea. Rack Mount Fiber Cabinet
- 02 ea. 6F Coupler Panel, 50 micron

Site Diagram

Demarc Extension

Client	Pratt Industries
Site	Cincinnati OH

IN STRICT CONFIDENCE. All rights reserved. Disclosure to third parties of this document or any part thereof, or the use of any information contained therein for purposes other than provided for by this document is not permitted, except with the express written permission of Scott M. Conkel and/or Georgia Low Voltage Technologies Inc.

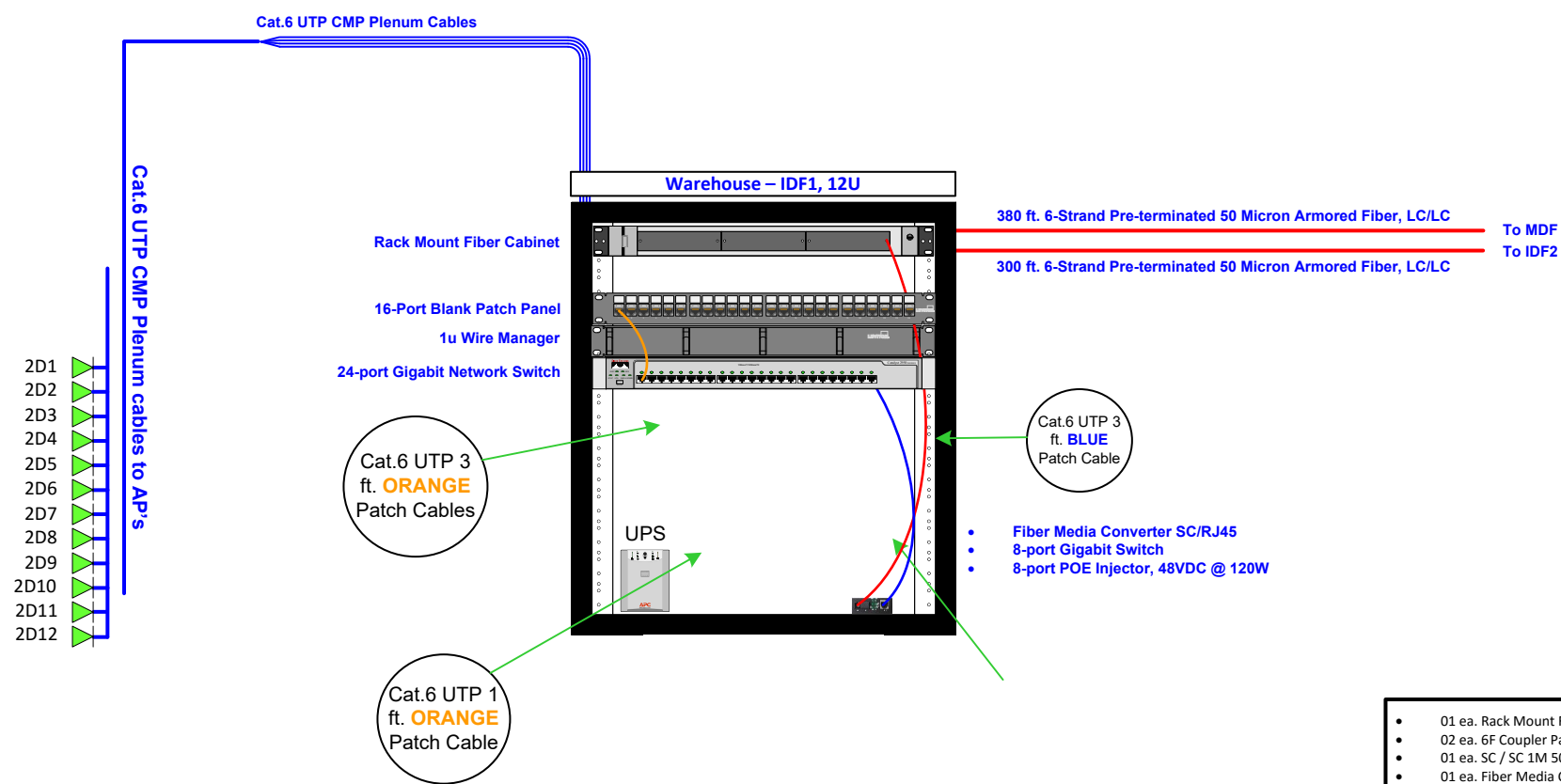

- 01 ea. Rack Mount Fiber Cabinet
- 02 ea. 6F Coupler Panel, 50 micron
- 01 ea. SC / SC 1M 50 Micron Fiber Patch Cable
- 01 ea. Fiber Media Converter, 10/100/1000 SC / RJ45
- 01 ea. 24-port Cat.6 Patch Panel
- 01 ea. 1U Wire Manager
- 01 ea. 24-port Gigabit Network Switch
- 08 ea. Cat.6 Modular Insert, **BLUE**
- 02 ea. 4-port wall plate
- 01 ea. 3 ft. Cat.6 Patch Cable, **BLUE**
- 08 ea. 1 ft. Cat.6 Patch Cable, **BLUE**
- 08 ea. 10 ft. Cat.6 Patch Cable, **BLUE**
- 01 ea. UPS
- 02 ea. Dual gang electrical box
- 02 ea. Mud Ring, dual to single gang
- **1990 ft. Cat.6 UTP Plenum Cable
- **380 ft. 6-strand 50 Micron Armored Fiber
- **70 ea. J-Hook with Beam Clamp (Cat.6)
- **65 ea. J-Hook with Beam Clamp (Fiber)

Site Diagram

Demarc Extension

Client	Pratt Industries
Site	Cincinnati OH

IN STRICT CONFIDENCE. All rights reserved. Disclosure to third parties of this document or any part thereof, or the use of any information contained therein for purposes other than provided for by this document is not permitted, except with the express written permission of Scott M. Conkel and/or Georgia Low Voltage Technologies Inc.

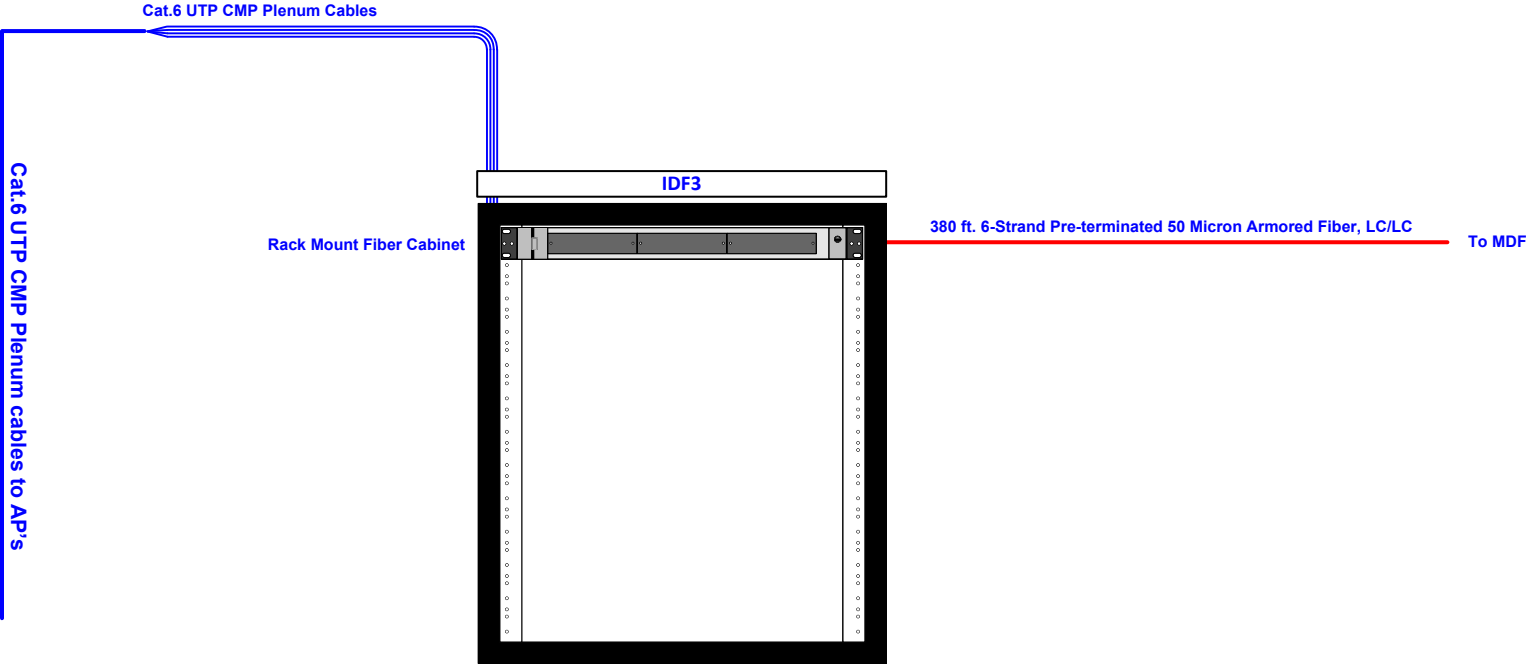

- 01 ea. Rack Mount Fiber Cabinet
- 02 ea. 6F Coupler Panel, 50 micron

Date	10/04/2016	
Diagram created for: Keith Estes, 678-374-5934		

Site Diagram

Demarc Extension

Client	Pratt Industries
Site	Cincinnati OH

IN STRICT CONFIDENCE. All rights reserved. Disclosure to third parties of this document or any part thereof, or the use of any information contained therein for purposes other than provided for by this document is not permitted, except with the express written permission of Scott M. Conkel and/or Georgia Low Voltage Technologies Inc.

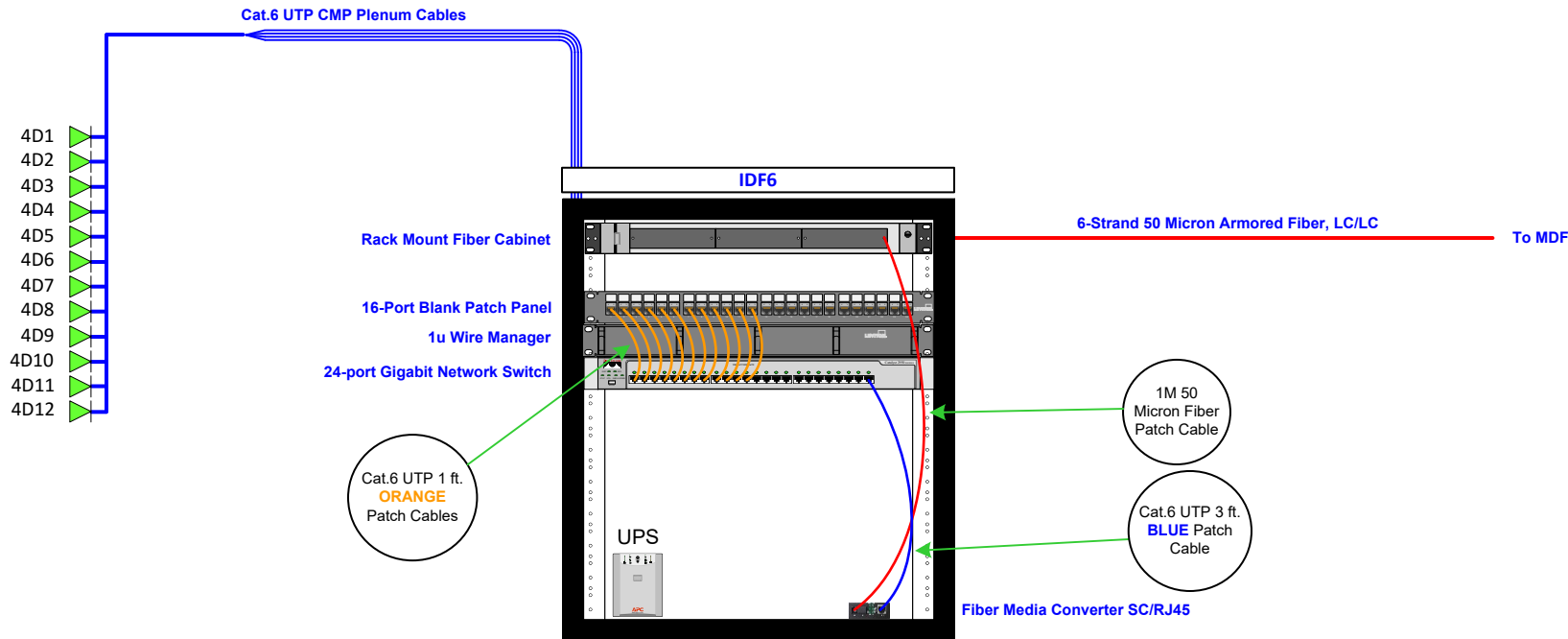

- 01 ea. Rack Mount Fiber Cabinet
- 02 ea. 6F Coupler Panel, 50 micron
- 01 ea. SC / SC 1M 50 Micron Fiber Patch Cable
- 01 ea. Fiber Media Converter, 10/100/1000 SC / RJ45
- 01 ea. 24-port Cat.6 Patch Panel
- 01 ea. 1U Wire Manager
- 01 ea. 24-port Gigabit Network Switch
- 12 ea. Cat.6 Modular Insert, **BLUE**
- 03 ea. 4-port wall plate
- 01 ea. 3 ft. Cat.6 Patch Cable, **BLUE**
- 12 ea. 1 ft. Cat.6 Patch Cable, **BLUE**
- 12 ea. 10 ft. Cat.6 Patch Cable, **BLUE**
- 01 ea. UPS
- 03 ea. Dual gang electrical box
- 03 ea. Mud Ring, dual to single gang
- **1990 ft. Cat.6 UTP Plenum Cable
- **380 ft. 6-strand 50 Micron Armored Fiber
- **70 ea. J-Hook with Beam Clamp (Cat.6)
- **65 ea. J-Hook with Beam Clamp (Fiber)

Site Diagram

Demarc Extension

Client	Pratt Industries
Site	Cincinnati OH

IN STRICT CONFIDENCE. All rights reserved. Disclosure to third parties of this document or any part thereof, or the use of any information contained therein for purposes other than provided for by this document is not permitted, except with the express written permission of Scott M. Conkel and/or Georgia Low Voltage Technologies Inc.

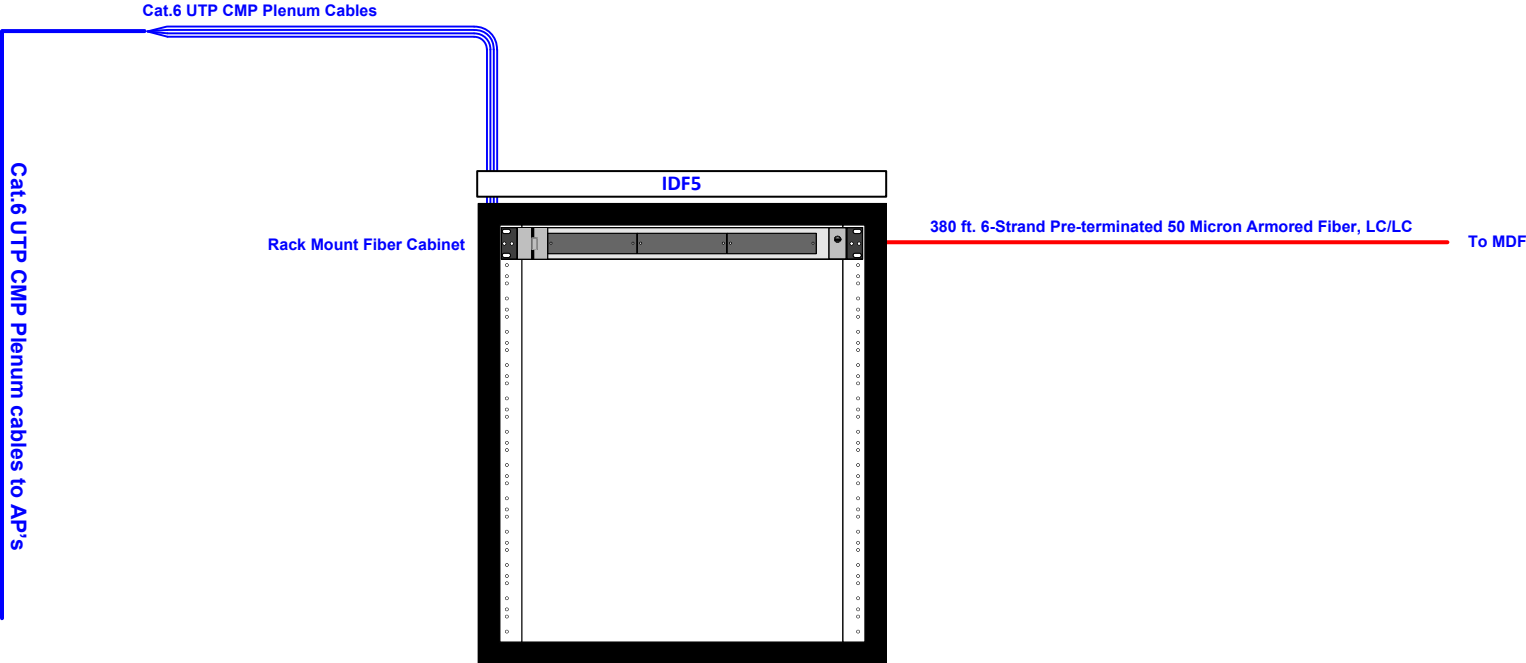

- 01 ea. Rack Mount Fiber Cabinet
- 02 ea. 6F Coupler Panel, 50 micron

Date	10/04/2016	
Diagram created for: Keith Estes, 678-374-5934		

Site Diagram

Demarc Extension

Client	Pratt Industries
Site	Cincinnati OH

IN STRICT CONFIDENCE. All rights reserved. Disclosure to third parties of this document or any part thereof, or the use of any information contained therein for purposes other than provided for by this document is not permitted, except with the express written permission of Scott M. Conkel and/or Georgia Low Voltage Technologies Inc.

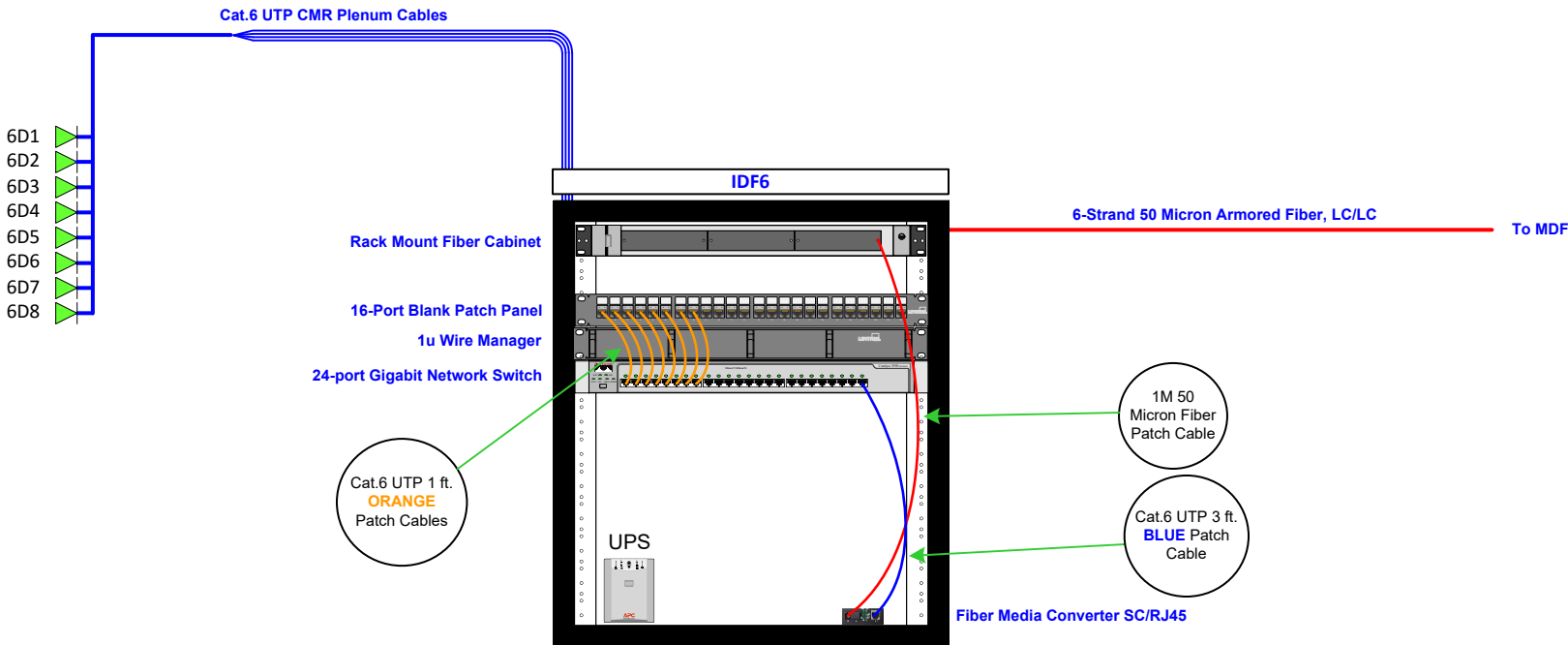

- 01 ea. Rack Mount Fiber Cabinet
- 02 ea. 6F Coupler Panel, 50 micron
- 01 ea. SC / SC 1M 50 Micron Fiber Patch Cable
- 01 ea. Fiber Media Converter, 10/100/1000 SC / RJ45
- 01 ea. 24-port Cat.6 Patch Panel
- 01 ea. 1U Wire Manager
- 01 ea. 24-port Gigabit Network Switch
- 08 ea. Cat.6 Modular Insert, **BLUE**
- 02 ea. 4-port wall plate
- 01 ea. 3 ft. Cat.6 Patch Cable, **BLUE**
- 08 ea. 1 ft. Cat.6 Patch Cable, **BLUE**
- 08 ea. 10 ft. Cat.6 Patch Cable, **BLUE**
- 01 ea. UPS
- 02 ea. Dual gang electrical box
- 02 ea. Mud Ring, dual to single gang
- **1990 ft. Cat.6 UTP Plenum Cable
- **380 ft. 6-strand 50 Micron Armored Fiber
- **70 ea. J-Hook with Beam Clamp (Cat.6)
- **65 ea. J-Hook with Beam Clamp (Fiber)

Site Diagram

Warehouse Conduit

IN STRICT CONFIDENCE. All rights reserved. Disclosure to third parties of this document or any part thereof, or the use of any information contained therein for purposes other than provided for by this document is not permitted, except with the express written permission of Scott M. Conkel and/or Georgia Low Voltage Technologies Inc.

